

## Capsule

**MIEPL** make Low Pressure Gauge measuring system. This Pressure Gauge are used in Low pressure application area in liquid and gaseous. This is widely used for Food and Beverages, Oil and Gas industries & OEM application.



## FEATURES

- ⇒ Compact design
- ⇒ Stainless steel case
- ⇒ Zero adjustment on dial
- ⇒ Low pressure application (<0.6 mbar)

## APPLICATION

- ⇒ Food & Beverages
- ⇒ Clean- air applications

## REFERENCE

- ⇒ EN 837-3

## STANDARD SPECIFICATIONS

Dial size	: DN63 / DN100 / DN125 / DN150
Range	: -600...25...600 mbar
Mounting pattern	: Direct, Bottom connection
Process connection	: ½" NPT (M) / ½" BSP (M)
Ingress protection	: IP 54
Execution	: Dry

## STANDARD PARAMETERS

Accuracy	: CL 1.6
Ambient Temperature	: -40...+65°C
Service Temperature	: 100°C max.
Pressure limits	: Steady pressure up to 75% of FS value : No over-pressure
Weld joints	: Silver alloy brazing

## MATERIAL OF CONSTRUCTION

Sensing Element	: Welded capsule
Case & Ring material	: AISI 304 SS (Bayonet type)
Capsule	: Cu- alloy
Shank	: Cu- alloy
Movement mechanism	: Cu- alloy
Dial	: Aluminum, black graduation on white background : with external zero adjustment on dial
Pointer	: Fixed, aluminum, black powder coated
Gaskets, Blow off disc & filling plug	: Neoprene / NBR
Window	: Sheet glass

## TEMPERATURE EFFECT

Please refer clause no 9.3 of EN 837-1

## DRAWING

DIMENSIONAL DRAWING

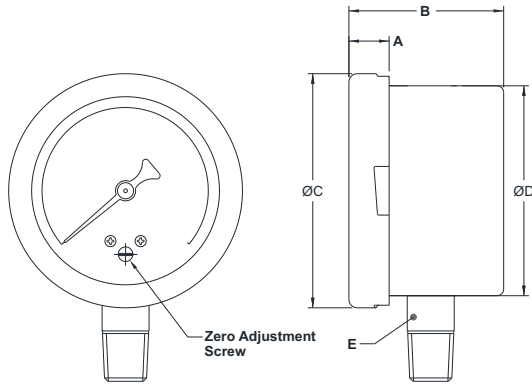

Type - 1A	
DN	63
A	12
B	43
ØC	70
ØD	62.5
E	SQ.14
Weight (gm)	240

DIMENSIONAL DRAWING

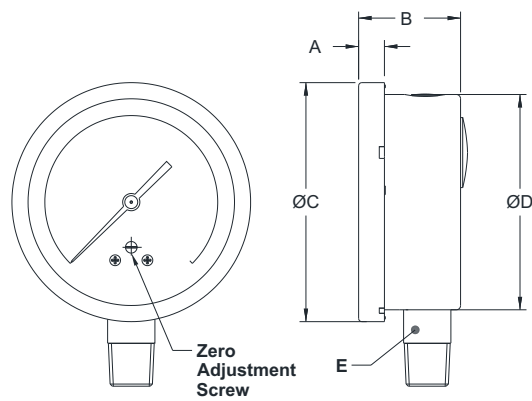

Type - 1A			
DN	100	125	150
A	12	15	15
B	48	48	48
ØC	111	129	161
ØD	100	118.5	149
E	SQ.22	SQ.22	SQ.22
Weight (gm)	540	730	950

DIMENSIONAL DRAWING

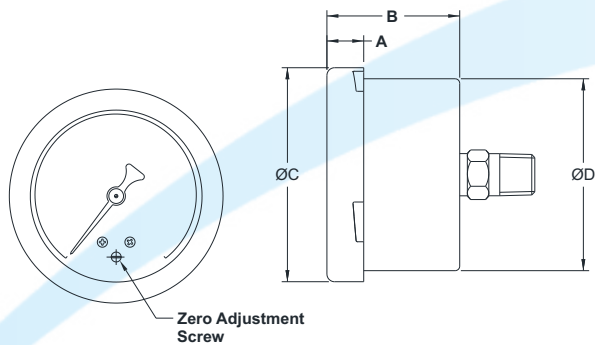

Type - 2A	
DN	63
A	12
B	43
ØC	70
ØD	69.7
E	62.5
Weight (gm)	240

All dimensions are in mm.

## DRAWING

DIMENSIONAL DRAWING

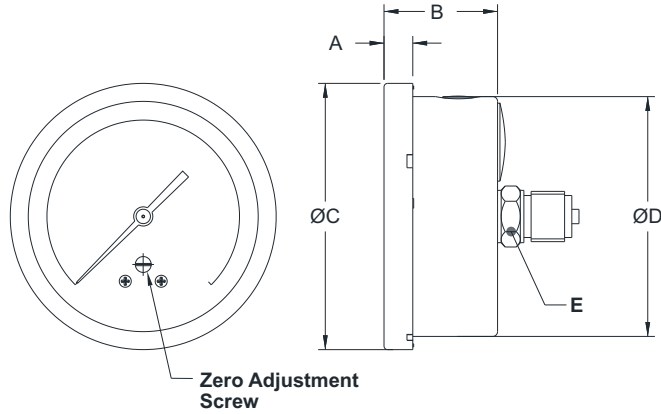

Type - 2A			
DN	100	125	150
A	12	15	15
B	48	48	48
ØC	111	129	161
ØD	100	118.5	149
E	SQ.22	SQ.22	SQ.22
Weight (gm)	540	730	940

DIMENSIONAL DRAWING

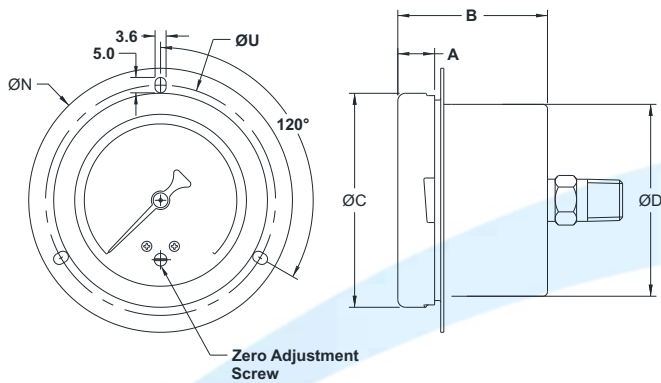

Type - 2C	
DN	63
A	12
B	43
ØC	69.7
ØD	62.5
ØN	86
ØU	75
Weight (gm)	240

All dimensions are in mm.

### ORDERING CODE

MP22 - D - XXX - 1A - 4NM - IP1 - E1

1. DIAL SIZE	63 mm / 2½"	C				
	100 mm / 4"	D				
	150 mm / 6"	F				
2. RANGE	Refer "Range Table"		XXX			
3. MOUNTING PATTERN	Direct Bottom connection			1A		
	Centre, Back connection			2A		
	Panel/Front flange mounting, Centre back connection			2C		
4. PROCESS CONNECTION	¼" BSP (M)				2BM	
	¼" NPT (M)				2NM	
	3/8" BSP (M)				3BM	
	½" BSP (M)				4BM	
	M20 X 1.5 mm (M)				4MM	
	½" NPT (M)				4NM	
	Other thread size and standards available on request. <sup>1</sup>					
5. INGRESS PROCESS	IP 54				IP1	
6. EXECUTION	Dry <sup>2</sup>					E1
7. OTHER OPTIONS	Case & Ring in AISI 316 SS (1A)	AA	Shatterproof safety glass	FC	SS tag plate, AISI 316 SS	WG
	Case & Ring in AISI 316 SS (2A)	AG	5 - point calibration certificate	SA	Custom designed dial	WR
	Case & Ring in AISI 316 SS (2C)	AI	Material test certificate 2.2	SM	Dial tag marking	WT
	Dampening screw, Brass	DO	Certification for Oxygen service	SO		
	Plexi glass	FB	SS tag plate, AISI 304 SS	WF		

Ordering Example : MP22 - D - XXX - 1A - 4NM - IP1 - E1

1. For other connections, please contact factory.
2. Case & Ring in AISI 316 SS from DN100 onwards.
3. DN63 available in mounting pattern 1A and 2A only.
4. DN63 available with ¼" connections. Other connections through adaptors.